

## MANUFACTURING CAPABILITY 2016



### CNC Milling

- 2 x Deckel Maho DMC 60T, 5 Axis, 5 Pallet 630 x 560 x 560mm, 18,000 rpm
- 1 x Deckel Maho DMC 60T, 5 Axis, 2 Pallet 630 x 560 x 560mm, 18,000 rpm
- 2 x Deckel Maho DMC104V Linear, 4 Axis, 1020 x 610 x 510mm 12,000 rpm
- 2 x Bridgeport Mouldmaster, 3 Axis, 1020 x 610 x 710mm, 12,000 rpm
- 2 x Deckel Maho DMC 80U, 5 Axis, 2 Pallet, 800 x 1050 x 800mm 12,000 rpm  
430 Nm Heavy Duty Spindle
- 1 x Deckel Maho DMC 65, 5 Axis, 3 Pallet 630 x 630 x 590mm, 18,000 rpm
- 1 x Deckel Maho DMC 125, 5 Axis, 2 Pallet, 1220 x 860 x 780mm 18,000 rpm
- 1 x Deckel Maho DMU 80T, 5 Axis, 860 x 600 x 600mm 18,000 rpm



### CNC Turning

- 1 x Mori Seiki NL2500-SY  
5 axis turning/milling with live tooling, sub-spindle & Y axis. 360 dia x 710 length
- 1 x Mori Seiki NL2500-Y  
5 axis turning/milling with live tooling & Y axis. 360 dia x 710 length
- 1 x Gildemeister CTX400E  
2 Axis turning/milling with live tooling. 305 dia x 460length
- 1 x OKUMA MULTUS B400II W  
Turning/milling with live tooling AND 5 AXIS Milling Head. 710 dia x 1500 length

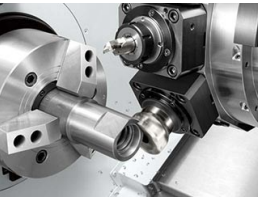

### Verification

- Starrett RGC2828-24 CMM**  
710 x 710 x 600mm capacity fitted with latest Virtual DMIS software
- Merlin 304020 CMM**  
760 x 1000 x 500mm capacity fitted with latest Virtual DMIS software
- Mitutoyo BHN 710 CNC CMM**  
750 x 1175 x 800mm capacity fitted with latest Virtual DMIS software
- Tesa Scan 52**  
Non contact radial measurement

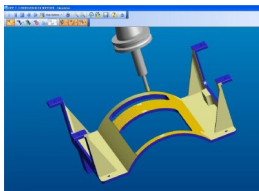

### Cad/Cam

- 1 x Catia V5, Seat
- 2 x EdgeCAM Seats 5 Axis
- 2 x POWERMILL Seats
- 2 x SOLIDWORKS 2016 Seats



### Sub-Assembly

- Wire inserts
- Freeze Fit Bushings
- Bearings
- Sealing
- Click Bond Nuts
- Screw Head Potting
- Electrical Bond Checking
- Swaging
- Lock Wire